

## MODEL: DSP29-8-S1

### Features and Benefits

- \* Higher Resistance to Dust, high quality condenser
- \* R290 Natural Refrigerant, promotes faster cool down and efficient energy consumption
- \* 3-year parts and labor, 5-year compressor warranty
- \* Stainless steel inside and outside, sealed interior floors and rounder cabinet corners for easy cleaning
- \* Self-closing doors with stay open feature.
- \* Adjustable, heavy duty shelves



### Technical Specifications

Voltage/Frequency	115V 60Hz
Refrigerant	R290
Type of Defrost	Automatic
Exterior Finish	Stainless steel
Interior Finish	Stainless steel
Net Weight	202 bs
Total Capacity	6.56 cu ft
Total Current	2.0A
Climatic Category	4/5
Nema Config.	5-15P

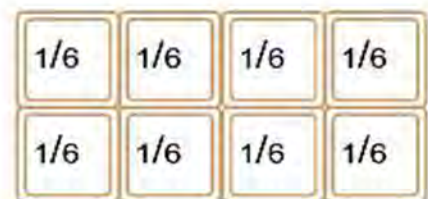

MODEL NO	TEMPERATURE RANGE ( °F )	EXTERNAL DIMENSION W X D X H (INCHES)	PACKING,CARTON W X D X H (INCHES)	DOOR	40GP CONTAINER CERTIFICATION
DSP29-8-S1	33°- 41° F	29" X 31 1/2" X 45 5/8"	30 1/2" X 33 1/8" X 50 3/4"	1	84

# FOOD PREP TABLE REFRIGERATOR - REGULAR

## MODEL: DSP29-8-S1

Model:	DSP29-8-S1
Rated Voltage:	115V AC
Rated Frequency:	60Hz
Total Input Power:	225W
Total Current:	2.0A
Total Capacity:	6.56 cu ft
Refrigerant:	R290/2.82 oz
Climatic Category:	4/5
Protection Type	I
Design pressure	High Side :300PSIG Low Side:150PSIG
Insulation Blowing Gas	C-pentane
Net Weight:	202 lbs
NEMA Cofig.	5-15P
1/6 Pan Count	8

## STANDARD FEATURES

### BACK MOUNT COMPRESSOR

The back mount compressor structure is placed in the coolest possible area, provides quick and easy service

### HIGH QUALITY STEEL

Interior and exterior high quality steel minimizes dents, scratches and rust

### HIGH DENSITY POLYURETHANE INSULATION CFC

free and high density cell foam is Eco-friendly and more energy efficient

### STURDY, CLEAN STAINLESS SHELVING

High quality coated stainless shelves may prevent peel and rust.

### SELF-CLOSING DOOR SYSTEM

Door Automatically close at 60°

REFRIGERATORS HOLDS 33°- 41° F FOR BEST IN REFRIGERATORS



NEMA 5-15P  
115/60/1

## PLAN VIEW

FRONT VIEW

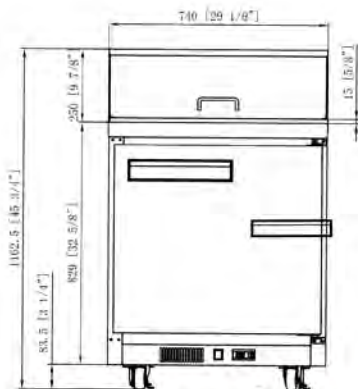

SIDE VIEW

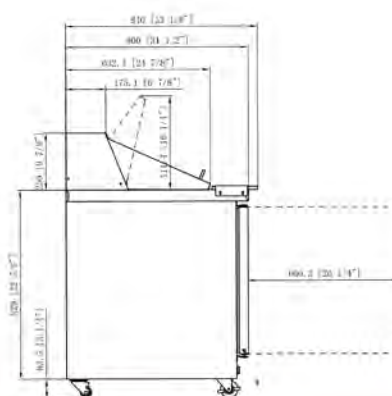

**New Jersey Office**  
4475 S. Clinton Ave,  
South Plainfield, NJ 07080  
(215) 808-8239  
Info@dukersusa.com

**Los Angeles Office**  
2460 Peck Road,  
City of Industry, CA 90601  
(562) 568-4060  
Info@dukersusa.com